

DISHWASHER VALVES

SPECIFICATIONS

N-42 model specification for the following part:

DW-42

This model provides the safety features of two valves in series within a single compact body.

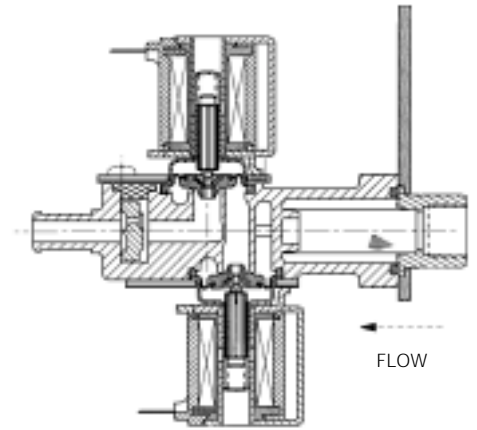
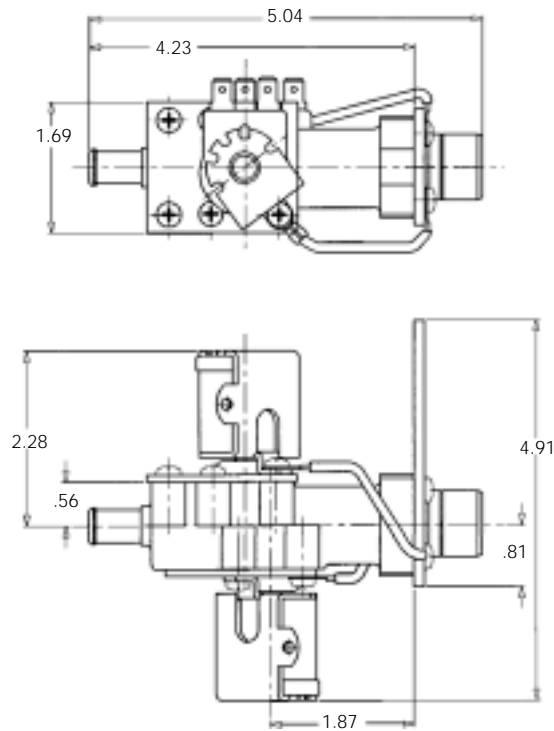

SPECIFICATIONS

S-53 Model specifications for the following parts:

- DW-53
- DW-54
- DW-55
- DW-57
- DW-59
- DW-60
- DW-61
- DW-63
- DW-64
- DW-66
- DW-67
- DW-69
- DW-70
- DW-71
- DW-72

The design combination of a brass inlet fitting and a mounting bracket allows direct connection to the supply plumbing without applying torque to the valve body. This valve model also has a reduced air gap operator, or water hammer suppression feature.

